



# JKTILES MACHINERY

An ISO 9001:2015 Certified Company.

*It All Starts With*

## THE ENDMOST **CONCRETE** PRODUCT **SOLUTION**





# **REVOLUTIONISING** **CONSTRUCTION**



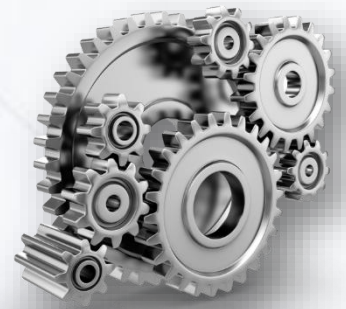

# JKTILES MACHINERY

*Machinery with brains*

An Iso 9001:2015 Certified Company.

**India's Largest Chain of Machinery Manufacturing** for making All types of **Pavement Tiles, brick, CC Blocks** in **secondary** industry Sector of manufacturing, Our national presence in **5 Major Indian States** -

- Bengaluru, Karnataka
- Hyderabad, Telangana
- Guwahati, Assam.
- Noida, Uttar Pradesh
- Delhi NCR
- Bhubaneshwar, Odisha

**J K T M**  
Specifications

**Prospectus** | **Overview**

- ▽ Endmost Concrete Product Solution
- ▽ Enthusiasm Customer Priority
- ▽ Incomparable product.
- ▽ Innovating Automation's

Mob : +91 96184 40701  
+91 72728 30786  
+91 7303075275

FB/page: JKTilesMachineryBangalore

Email : [Jktilesmachinery@gmail.com](mailto:Jktilesmachinery@gmail.com)  
[Jktilesmachinery3@gmail.com](mailto:Jktilesmachinery3@gmail.com)

Web: [Jktilesmachinery.org](http://Jktilesmachinery.org)

[Jktilesmachinery.com](http://Jktilesmachinery.com)

YouTube: [Jktilesmachineryhyderabad](https://www.youtube.com/Jktilesmachineryhyderabad)

FOLLOW US ON  
SOCIAL MEDIA



## PRODUCT *At a Glance*

### **Jk-Block Master Everest EV1600**

(Semi- automatic paver & brick manufacturing Plant with Superior Dimensional Accuracy of the finished product )



**Esteemed Machinery product partners**

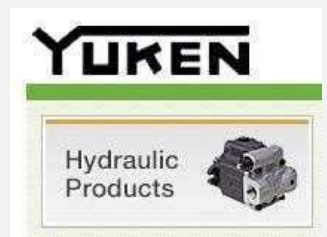

**Note:** All The Companies Given Above Are Only Our Manufacturing Partners, Which Provide Us All The Parts For The Manufacturing Of Machinery. These Includes Crompton™, Unbrako®, Dunlop™, Yuken®, Rexorth™, Schneider™, rajhans, ABB, etc.

# A Glimpse Of End Products Made From Jk-Block Master Everest EV1600



## Machine Features & All Specifications :-

**JKTM-SAT-EV1500 Block Master Jk-Block  
Master Everest EV1600 Hydro-Vibro  
solid/hollow Concrete block making machine.**

Multi Blocktech	Multi types of Brick & Block Manufacturing capacity.
Triple Vibration Tech.	Triple Vibro compaction technology with twin drive- Two Motor for powerful vibration system.
EN-8 carbon steel Rods and cylinders	High Carbon Engineered steel (BS 970 080m40) has high strength levels compared to normal bright mild steel, due to thermo-mechanical rolling, Non-bendable metal tempering and quenching process.
Auto. Vibration operation	Automatic vibration timers/relays and switch gears are installed in PLC to perform smooth & efficient vibration to executive the best compact and equal strength of each blocks/Bricks
Pressure control	Equipped with The oylor/yuken anticlockwise displacement vane pump designed for use in hydraulic systems where a reliable and efficient flow of fluid is required. With displacement of 50 cm3/rev with 15 Liters oil tank capacity and two mobile lever operated valves.
Machine travel system	Machine is equipped with motor-Gear and Chain system for the travelling of machine on the platform and for laying of all finished cc blocks
Pan Concrete Mixer	Pan mixer with 450kg. mixing capacity and 7.5 hp motor with worm reduction gear box capacity 19 Liter for speedy & smooth material mixing.
Water adding syst.	Automatic water adding system with water pump & Timer.
Auto Conveyor belt sytem	Automatic Conveyor Belt System Controlled By PLC panel.





## JKTM-SAT- EVEREST EV1600 Block Master Main Machine

**Machine Dimension (L x W x H): 1800mm x 1280mm x 1890mm**

**Machinery total power: 8.5 Hp**

**Motors Brand : Crompton® Greaves**

**PLC panel: Equipped with auto vibration and auto travel operation also Branded Load Contractors, MCCB, Delay timers, push start/ stop buttons for all motors are installed**

**vibrator type – Double Vibration twin Drive vibro tech.**

**Hydraulic Rods- EN-8 High Carbon Engineered steel (BS 970 080m40).**

**Body Frame:- All Heavy duty Metal MS 31 grade MS Angles And Channels from VIZAG & SAIL LTD. MS PIPES & tubes from Apollo brand, & MS Sheets From TATA, JSW SAIL Etc.**



## Pan Mixer

<b>Dimension</b>	<b>: 1524mm X 450mm</b>
<b>motor</b>	<b>: 7.5 HP Crompton® Greaves</b>
<b>Gear Box</b>	<b>: 22 liters</b>
<b>Blade System</b>	<b>: Roller / Blade</b>
<b>Capacity</b>	<b>: 450 Kgs</b>



## PLC Computerized Panel

**Electronic Parts: All heavy Load contractors, MCCBs, Delay timers, switch circuits, start/stop buttons, complete wiring and other electronic or electrical components are supremely branded.**

**Panel Body: Dust & vermin proof Panel suitable for bottom cable entry.**

**Vibration Auto:- Auto-timer vibration facility with limit switch safety feature.**



## Main Hydraulic Punch

**: 4/6/9/12 etc. Cavity Punch**

**: 31 grade iron.**

**: High Density Tempered**

**: 2 HP Vibration motor.+ 2 hp Double**

**: vibrator type – double/ Triple (Optional in JKTM-SAT-1550 Model)**

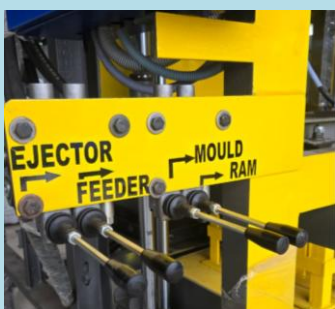

## Hydraulic pressure Control mobile Lever valve block set

**: Streamline your concrete production with our advanced main feeder system. The integrated hopper ensures precise and consistent material flow, guaranteeing accurate batching and superior quality concrete every time. Its compact design and efficient operation minimize waste and maximize productivity for optimal project delivery.**

**MS Angles And Channels from VIZAG & SAIL LTD.**



### **Triple Vibration Technology (TRI-3 drive vibro tech)**

- : Triple Vibration TRI-3 drive technology for
- : Heavy duty three mechanical Mega Vibrators
- : High Density EPDM Tempered iron Fittings for Anti-shock and absorption
- : 2.5 HP(1 HP + 1 HP + 0.5 HP) Vibration motor connected with two mechanical vibrators
- : Vibrator type – triple vibration

**2 Bottom Die Vibrator + 1 Top Ram Punch Vibrator = Triple Vibrator Technology For Best Compaction, Strength, Height Accuracy, Corner Finishing & Dimensional Accuracy.**



### **Pressure Power Pack Assembly**

- : 5 Hp Pressure induction motor
- : 15 liters oil tank capacity
- : 45 LPM Oyler/Yuken VANE pump
- : Heavy Duty Anti-heat hose pipe and fitting
- : Heavy Duty rajhans/techno land oil seal.
- : Hydraulic: 35 LPM Oyler/Yuken Vane pump and assembly(HSCS) Hydraulic Speed Control System.



### **Concrete Feeder + hopper System**

: Streamline your concrete production with our advanced main feeder system. The integrated hopper ensures precise and consistent material flow, guaranteeing accurate batching and superior quality concrete every time. Its compact design and efficient operation minimize waste and maximize productivity for optimal project delivery.  
MS Angles And Channels from VIZAG & SAIL LTD.



### **Finished Product Ejector System**

Maximize efficiency with our automated ejector system. It rapidly and precisely discharges finished concrete products from molds, eliminating manual labor and accelerating your production cycle. Minimize product damage, increase throughput, and ensure consistent quality with this essential automation solution.



### Conveyor Belt System

Motor : 2 Hp

Gear Box : 3 liters

- To feed the mix from the pan mix to the concrete hopper storage system, Maximize efficiency with our automated conveyor system. It rapidly and precisely discharges finished concrete mortar into the hopper storage system, operated automatically by PLC panel Unit.



### Hydraulic cylinders punch and Cavity System

Introducing first EN 8 Anti Heat/bend Hydraulic technology to achieve -

- Best Strength and Designed Impression on Each piece.
- Précised Dimensional Accuracy.
- Uniform Size with Controlled Height.

Maximize efficiency with our semi automated Hydraulic cylinders punch and Cavity System. Guided rods with en8 grade rods and bushes for extreme durability.

## Requirement & Extra Needs

### Extra need to Buy Or Arrange



Recycle Ply  
Pallets

Bharat Recycle Pvc Ply sheet is generally used as Brick Pallets, It's Eco-Friendly Products because prepared from Plastic & wood Scrape Material.

600 pcs.

Rate will be  
Extra

600pcs. or more as per your requirement  
Size will be given after machinery Mfg. work start.

Hydraulic  
Oil

450 Liters 68no. Hydraulic Oil

450 liters

Note: Hydraulic Oil & Recycle Ply Pallets should be buy from Locally Or We can Arrange but you need to pay extra charges.

## Shade Area Complete Mapping

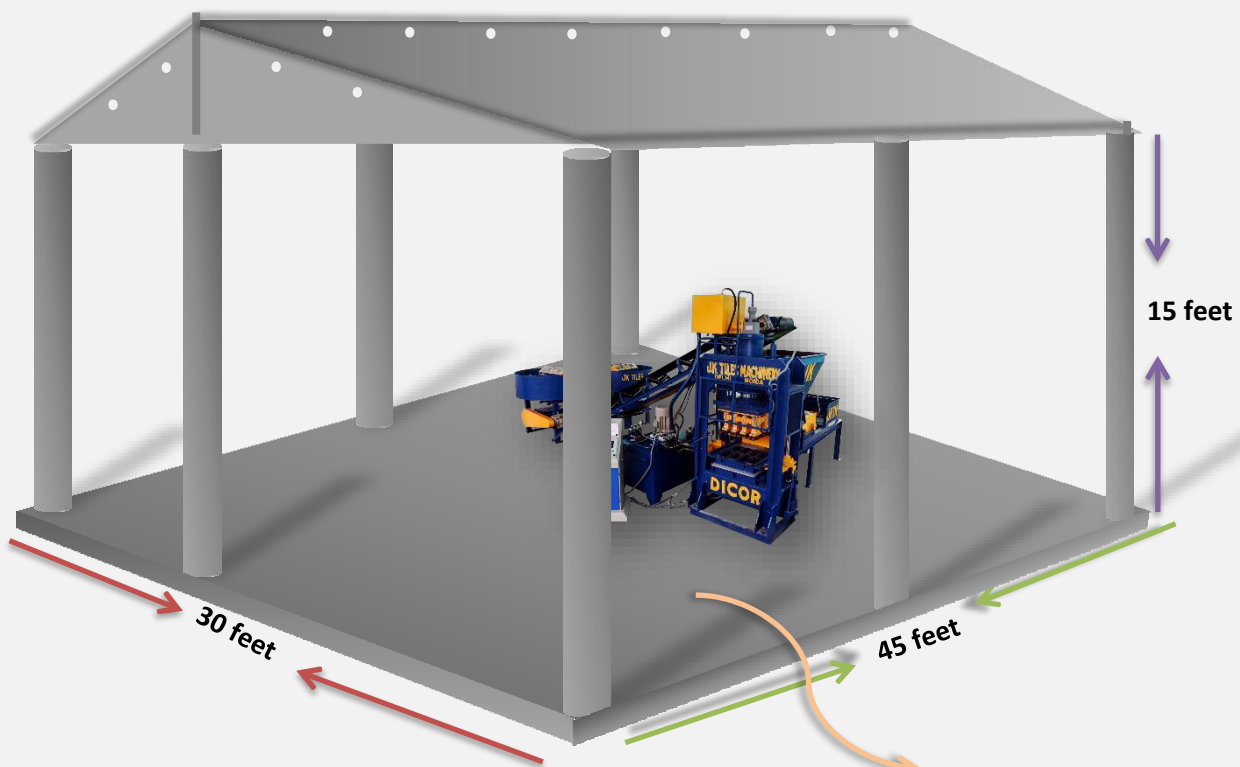

ConcreteBaseDimension ( LXBXH):- 40' X60' X5



# Electrical, Production & production for JKTM-SAT- EVEREST EV1600 Block Master machine.

Electricity Source Required (3 Phase 440 volts).

1. Electricity (common)	2. Diesel Generator(D.G)
Total Machine Power load (including mixer): <b>17 (HP)</b> Electric meter Required : <b>12 (KW)</b> Machine Power Load :- <b>9.5 Hp</b> ,Mixer Power load :- <b>7.5 Hp</b>	Total Machine Power load : <b>17 (HP)</b> Diesel Generator (D.G) Required : <b>24(KVA)</b>

**Concrete End Products Standard Sizes & Production Output Table**

Concrete Products	S.no		Sizes			No. Of Blocks/Stroke	Total No. Of Blocks In 8 to 9 hour shift (approx. *ref. to note.)
			L	W	H		
	1.	Concrete Blocks	300	200	200	3	1800 pcs(approx.)
	2.	Concrete Blocks	300	100	200	6	3600pcs.(approx.)
	3.	Concrete Blocks	300	150	200	4	2400pcs.(approx.)
	1.	Concrete Blocks	400	200	200	3	1800 pcs(approx.)
	2.	Concrete Blocks	400	100	200	6	3600pcs.(approx.)
	3.	Concrete Blocks	400	150	200	4	2400pcs.(approx.)
	4.	Cement Brick	225	100	75	10pcs.	4800 to 6000 pcs.(approx..)

**\*Note :- (8-9 Hours production) (1 to 1.25 cycles per minute depending upon number of labours and there manpower speed, batching input speed to mixers, conveyors & hopper.)**

**Weight of the finished blocks approx. and production images of application areas.**



HOLLOW BLOCKS	
	Hollow Block 12" (200 X 300 X 400) Weight (kg) : 32
	Hollow Block 10" (200 X 250 X 400) Weight (kg) : 31
	Hollow Block 8" (200 X 200 X 400) Weight (kg) : 23
	Hollow Block 6" (200 X 150 X 400) Weight (kg) : 18
	Hollow Block 4" (200 X 100 X 400) Weight (kg) : 14



# JKTM-SAT-EV1500 Block Master Jk-Block Master Everest EV1600 Hydro-Vibro solid/hollow Concrete block making machine.

---

**1. Triple Vibration twin drive technology:-** The Semi-Automatic Block Making Machine utilize **Double Vibration twin drive technology** , Keeping the precise and parallel movement between tamper and mould and avoiding its deformation. With the twin drive double vibration, major advantages are **accurate height precision, overall dimension accuracy of all the blocks, ultimate compaction of the concrete by removing all air pockets** the product gives proper control on the immediate start and half of the motors, preventing the motor from overheating caused by long term operation. As the vibration efficiency increases, The production rate will rise correspondently.

**2. Double High Dynamic Directional Valves.** This semi- automatic block making machine utilizes double proportional and directional Valves with high activity to regulate the oil flow and pressure by mobile lever valve efficiently, which plays a buffer role in the process of production. And this kind of design of machinery can ensure the stable production and prolong the lifetime and durability of all parts of machine.

**2. Hydraulic movement Shafts EN-8 Metal:- High Carbon Engineered steel** (BS 970 080m40) has high strength levels compared to normal bright mild steel, due to **thermo-mechanical rolling, metal tempering and quenching process**.

**3.PLC Control System with Remote control feature.** Electrical system machinery equipped The control system is of Easy operation and low failure ratio. The machinery is equipped with data input and output device and data formula function. The visualized controls at front panel are characterized by simple operation. The All-electrical components like contractors, relays, switches even buttons on Control Panel are from Standard Makes Which give high performance and execute all operation efficiently.

**4. Shaft Rotation & Compulsory Feeding** The Automatic block making Machine is designed with the feeding device rotating at high speed. The raw can be blended evenly to make the blocks with optimal density and intensity.with uniform feeding the product is available in utilization different raw materials and moulds. The feeding frame bottom plate & mixing blades are made of high-duty HARDOX Steel, which strengthens the sealing performance and prevent the material leakage. The discharging gate is controlled by feeder reverse/forward system.

**5. Heavy Duty Structure and wear resistance Molds.** Heavy duty structure and wear resistance moulds adopts CNC & Wire Cutting to Make sure paver size accuracy. Carbon-dioxide welding for crack resistance with heat treatment and carburization, sand blasting and other machining Process. It becomes more robust and resistant to the frequent & strong vibrations. The hardness reaches up to HRC52. In addition to heat treatment, we use stress relief process as another protection to the moulds and the other main parts of the machine.

**6. High- Precision Guide Bearing & Highly Efficient Hydraulic System** High-Precision guide bearings are used to assure the precise movement between the temper head and the mould. Heavy duty machine frame uses high-intensity steel and advanced heat treatment for making wear resistance. The Hydraulic pump & valve are from international brand. Adopt high-dynamic Proportional valve and constant output pump to adjust the oil speed & pressure, With the features of high-stability, high-efficiency and energy-saving



## Our Branches

---

### Come reach us



*We Hope You Find Our Above Prospectus To Your Whole Satisfaction By All Terms, We Request You To Kindly Place Your Valuable Orders, Which Receive Our Best Attention And Promote Execution. Hope That We Can Establish A Good Business Relationship In The Nearest Future.*

*Thanks.*

Mob :+91 9618440701  
+91 7272830786

Email :[Jktilesmachinery5@gmail.com](mailto:Jktilesmachinery5@gmail.com)  
[Jktilesmachinery@gmail.com](mailto:Jktilesmachinery@gmail.com)  
[Jktilesmachinery3@gmail.com](mailto:Jktilesmachinery3@gmail.com)

Web : [Jktilesmachinery.com](http://Jktilesmachinery.com)  
[Jktilesmachinery.co.in](http://Jktilesmachinery.co.in)



FB/page: JKTilesMachinery

FOLLOW US ON  
SOCIAL MEDIA



## Few Of Our Esteemed Clients



**Dr. PATNAM MAHENDER REDDY  
INSTITUTE of MEDICAL SCIENCES**



Branches:- Hyderabad, Delhi NCR , Noida, Bangalore, Guwahati Bhubneshwar.

All Addressess And Website Are Given In on 11<sup>th</sup> page,Also this brochure is for general product knowledge approximation Idea and Do Not Claim to be to be hundred percent precise, so its is advised to take physical demo & meeting with sales executive and Machinery.

All Copyrights & Trademarks Reserved By JK Tiles